



F436 Structural Flat Washer

The material and heat treatment are per the requirements specified by ASTM F436 for Type 1 steel

Material – Medium Carbon Steel

Hardness – Up to 1 1/2” Through Hardened to Rc 38/45

Sizes above 1 1/2” may be case hardened.

Dimensions are per ASTM F436.

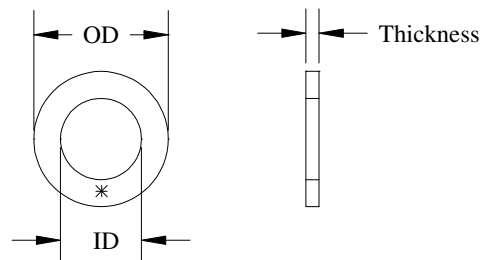

| Size (Bolt Dia) | Inside Diameter | | | Outside Diameter | | | Thickness | |
|--------------------|-----------------|-------|-------|------------------|-------|-------|-----------|------|
| | Nom | Max | Min | Nom | Max | Min | Max | Min |
| 1/2 | 17/32 | .531 | .500 | 1 1/16 | 1.094 | 1.031 | .177 | .097 |
| 5/8 | 11/16 | .688 | .657 | 1 5/16 | 1.344 | 1.281 | .177 | .122 |
| 3/4 | 13/16 | .812 | .781 | 1 15/32 | 1.500 | 1.438 | .177 | .122 |
| 7/8 | 15/16 | .938 | .907 | 1 3/4 | 1.781 | 1.719 | .177 | .136 |
| 1 | 1 1/8 | 1.125 | 1.094 | 2 | 2.031 | 1.969 | .177 | .136 |
| 1 1/8 | 1 1/4 | 1.250 | 1.219 | 2 1/4 | 2.281 | 2.219 | .177 | .136 |
| 1 1/4 | 1 3/8 | 1.375 | 1.344 | 2 1/2 | 2.531 | 2.469 | .177 | .136 |
| 1 3/8 | 1 1/2 | 1.500 | 1.468 | 2 3/4 | 2.781 | 2.719 | .177 | .136 |
| 1 1/2 | 1 5/8 | 1.625 | 1.594 | 3 | 3.031 | 2.969 | .177 | .136 |
| 1 3/4 | 1 7/8 | 1.875 | 1.812 | 3 3/8 | 3.438 | 3.312 | .280 | .178 |
| 2 | 2 1/8 | 2.125 | 2.062 | 3 3/4 | 3.812 | 3.688 | .280 | .178 |
| 2 1/4 | 2 3/8 | 2.375 | 2.312 | 4 | 4.062 | 3.938 | .340 | .240 |
| 2 1/2 | 2 5/8 | 2.625 | 2.562 | 4 1/2 | 4.562 | 4.438 | .340 | .240 |
| 2 3/4 | 2 7/8 | 2.875 | 2.812 | 5 | 5.062 | 4.938 | .340 | .240 |
| 3 | 3 1/8 | 3.125 | 3.062 | 5 1/2 | 5.562 | 5.438 | .340 | .240 |